

QUICK CHANGE TOOL POST WITH MULTI TOOL HOLDERS

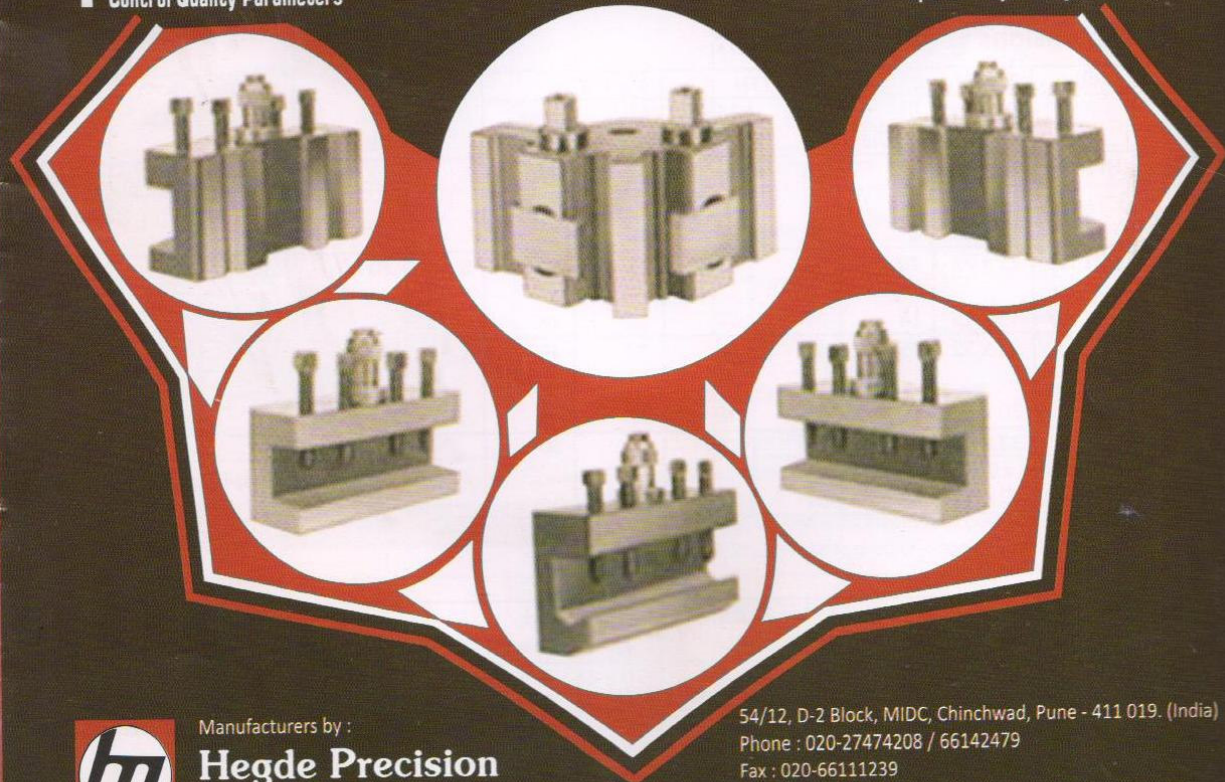

- Increase Productivity
- Control Quality Parameters

- Minimize Setting Time
- Repeatability & Long Life



Manufacturers by :
**Hegde Precision
Engineering Works**
(An ISO 9001 : 2008 Company)

54/12, D-2 Block, MIDC, Chinchwad, Pune - 411 019. (India)
Phone : 020-27474208 / 66142479
Fax : 020-66111239
E-mail : hegdeprecision@gmail.com
 hegdeprecision63@rediffmail.com
Website : www.hegdeprecision.co.in

Basic Specifications are:

Model	Tool Shank Size	Suitable for Lathe
H.P 075	12 mm sq to 20 mm sq	G.D. Weiler & bench type lathe
H.P 150	15 mm sq to 25 mm sq	Centre HT 150 - 180 mm & upto 3 HP
H.P 210	20 mm sq to 32 mm sq	Centre HT 180 - 250 mm & upto 15 HP
H.P 315	20 mm Sq to 40 mm Sq	Centre HT 250 to 350 mm, Bombay Lathe

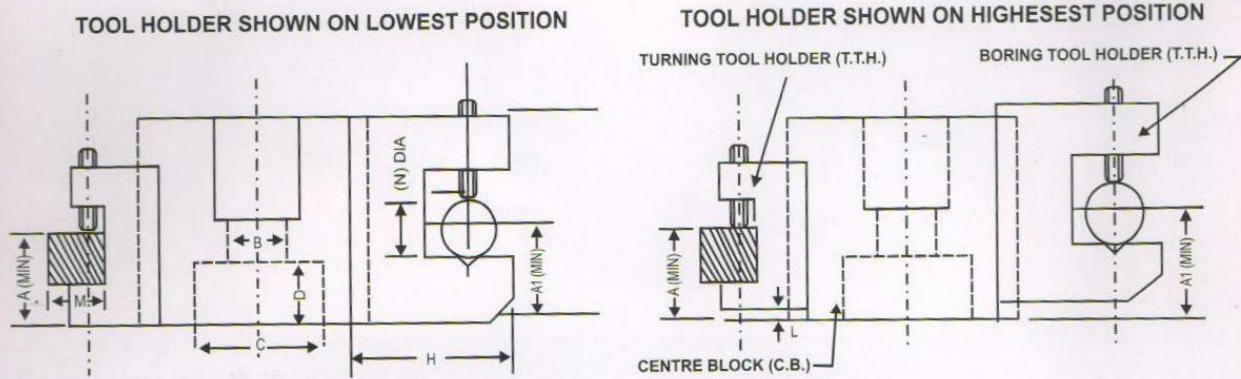

Dimensions Specifications Chart

Model	Tool Shank Size		A for TTH		A for BTH		L (Lift)	B Dia. Max.	C Dia. Max.	D Max.
	Turning M.Sq.	Boring N. Dia	Min.	Max	Min.	Max.				
HP075	16 x 16	12	28	34	19	24	8	12.5 H7	12 H7	27
	12 x 12	8	24	30	16	22				
HP150	25 x 25	20	39	47	21	29	8	20 H7	50	15
	15 x 15	16	29	37	18	26				
HP210	32 x 32	25	46	58	37	49	12	22 H7	38	30
	20 x 20	20	34	46	33	45				
HP 315	32 x 32	30	56	76	40	60	20	25	44	35
	40 x 40	40	64	84	44	64				

Model	Center Block (L x B x H)	TTH (H x B x L)	BTH (H x B x L)
HP210	132 x 132 x 82	70 x 45 x 140 Long	70 x 45 x 140 Long
HP150	111 x 111 x 63	55 x 40 x 110 Long	55 x 40 x 110 Long
HP075	96 x 96 x 53	47 x 32 x 100 Long	37 x 47 x 100 Long
HP315	170 x 170 x 110	60 x 90 x 180 Long	60 x 90 x 180 Long

Material Specifications Chart:

	Main Body	Turning Tool Holder / Boring Tool Holder	Bend & T-Handle	Tool Clamping Bolts
Material	S.G. Iron Casting	EN32 B / 20MnCr5	EN8	EN8
Heat Treatment	Case Hardened to 1.0 to 1.5 mm	Case Hardened to 0.6 to 0.8 mm	Toughened	Toughened
Hardness	54 to 60 HRC	54 to 58 HRC	30-35 HRC	30-35 HRC

Features:

- | | |
|--|--|
| <ol style="list-style-type: none"> 1. Tool Changing within split second 2. Guaranteed Tool positioning accuracy within 0.005 mm 3. Parts made of alloy steel 4. Hardened and Ground ensuring long life | <ol style="list-style-type: none"> 5. Number of extra operation possible with pre-set tools and special accessories 6. Increased productivity 7. Minimum setting time 8. Controlled quality parameters 9. Repeatability & long life |
|--|--|



Drilling Tool Holder



Parting Tool Holder

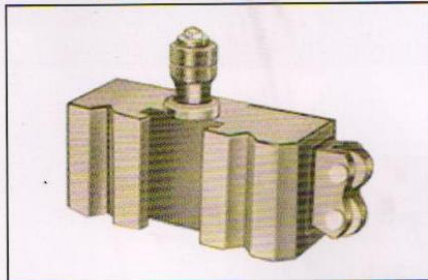

Knurling Holder

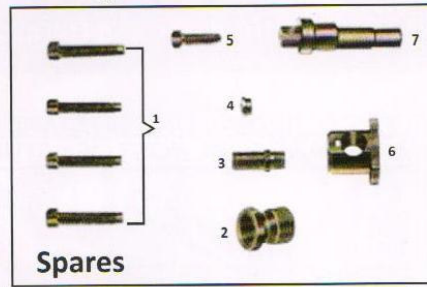

Spares

1. Square Head Bolts –M10 x 50 / M10 X 40 –Set of 4
 2. Thimble, 3. Ferrule, 4. Step Washer, 5. Square Head Bolt –M8 x 32, 6. Clamping Piece, 7. Eccentric Pin
- Height Adjustment Assembly –Assembly of 2, 3, 4 & 5

Suitability Chart

HP - 150

Suitable for

Kirloskar Hi-Cut Mafras GD 1 D2, Enterprises 1330, PSG 141, Tiger GD Weiler, Energy, GMM2, MMM 170 Series, New Dilip 162 mm, Model 1 & 2, Ganesh Machines, Anil Model 1 to 4 Lathes Venus HG 31, Venu HG 41, Sukan SU-37 & all 4½ Lathes.

HP - 210

Suitable for

HMT Vikram, Qetkos Chamundi, LB 17, 22, 26 NL 22, 26, PSG 124, Kirloskar Simoga Enterprises 1550, 1675, 1810, 2215, Sagar, Atul No 1 to 4, MMM 200 Series Nagmati, Sharad 1 & 2 Lathes, Sukun SU - 41, Venus HG 50 and all similar medium & heavy sized lathes.

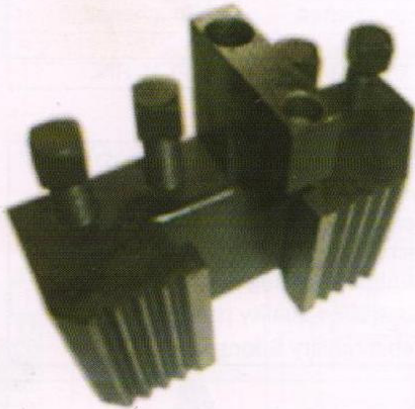

Special Copying Tool Holder



Special Boring Bar Holder

Instructions and Details required for Selection of QCTP model

TYPICAL DIMENSIONS OF STANDARD SQUARE TOOL POST OF LATHE

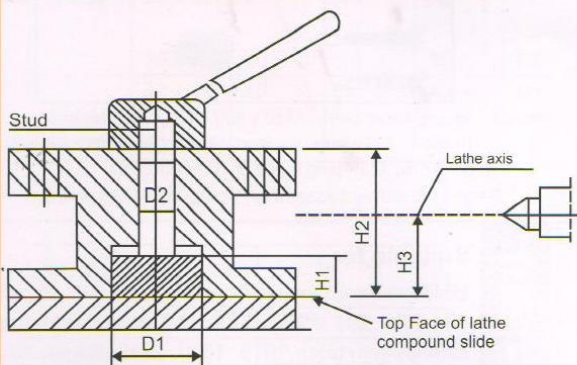

1. Specify Make, Model of Center Lathe for which QCTP is needed
2. Specify Center Height of Lathe
3. Specify Horse Power of lathe
4. Measure D1 with micrometer and specify
5. Measure D2 with micrometer and specify
6. Mention H1, H2 and H3 correctly